



www.scotchman.com

P/N 060222
INSTRUCTIONS

CPO-250, CPO-275
CPO-350, CPO-350NF*

*S/N B1822NF0509 and Prior

April 2022

060222 Replacement Instructions

The following instructions describe how to replace a Kraus & Neimer cam switch with a direct replacement cam switch on the machine(s) listed below. For machines built prior to April 2022 with Klockner Moeller cam switches, see [Page 3](#).

DISCONNECT POWER TO THE MACHINE BEFORE MODIFICATION.

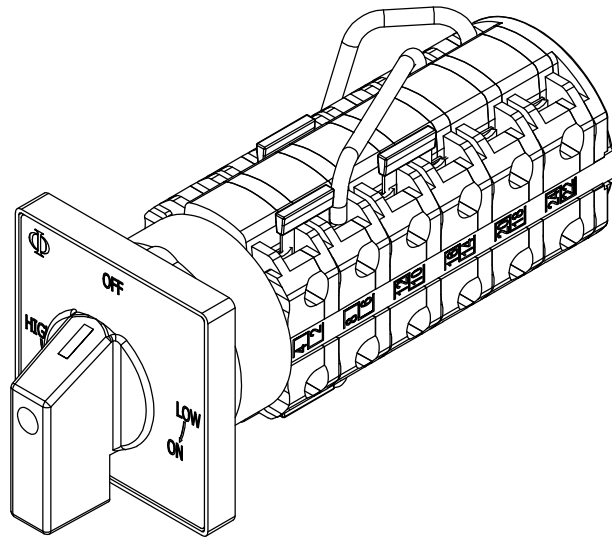

060222

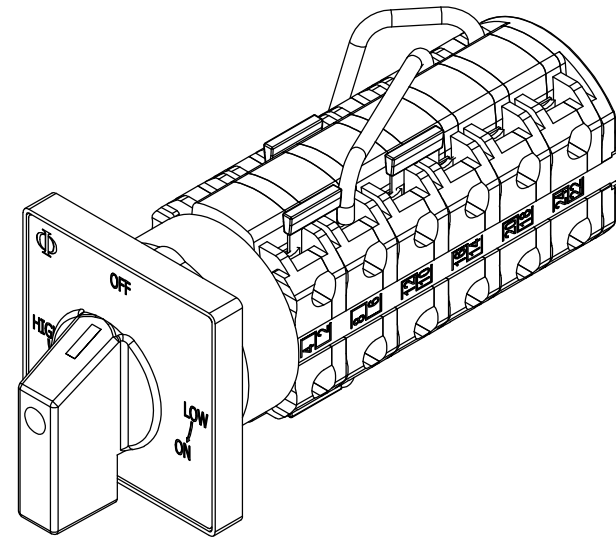
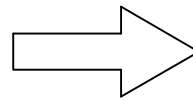

060222

Applies to Serial Numbers:

CPO 275: B39330422 & After

CPO 350: B121460422 & After

Switch Removal & Replacement

1. Disconnect power to the machine.
2. Remove the 4 - M4 screws (A) retaining the lid (B) to the enclosure. Remove lid.
3. Loosen the screw (C) retaining the switch knob (D). Remove knob.
4. Remove the legend plate (E).
5. Remove the 2 - screws (F) retaining the legend holder (G) to the enclosure. Remove legend holder.
6. The switch (H) is now free to be carefully pulled back to allow access to the wires.
7. Note the location of each wire and replace the switch.
8. Make sure to place each wire in the same terminal as the original location.
9. Reverse the steps above to install the new switch.

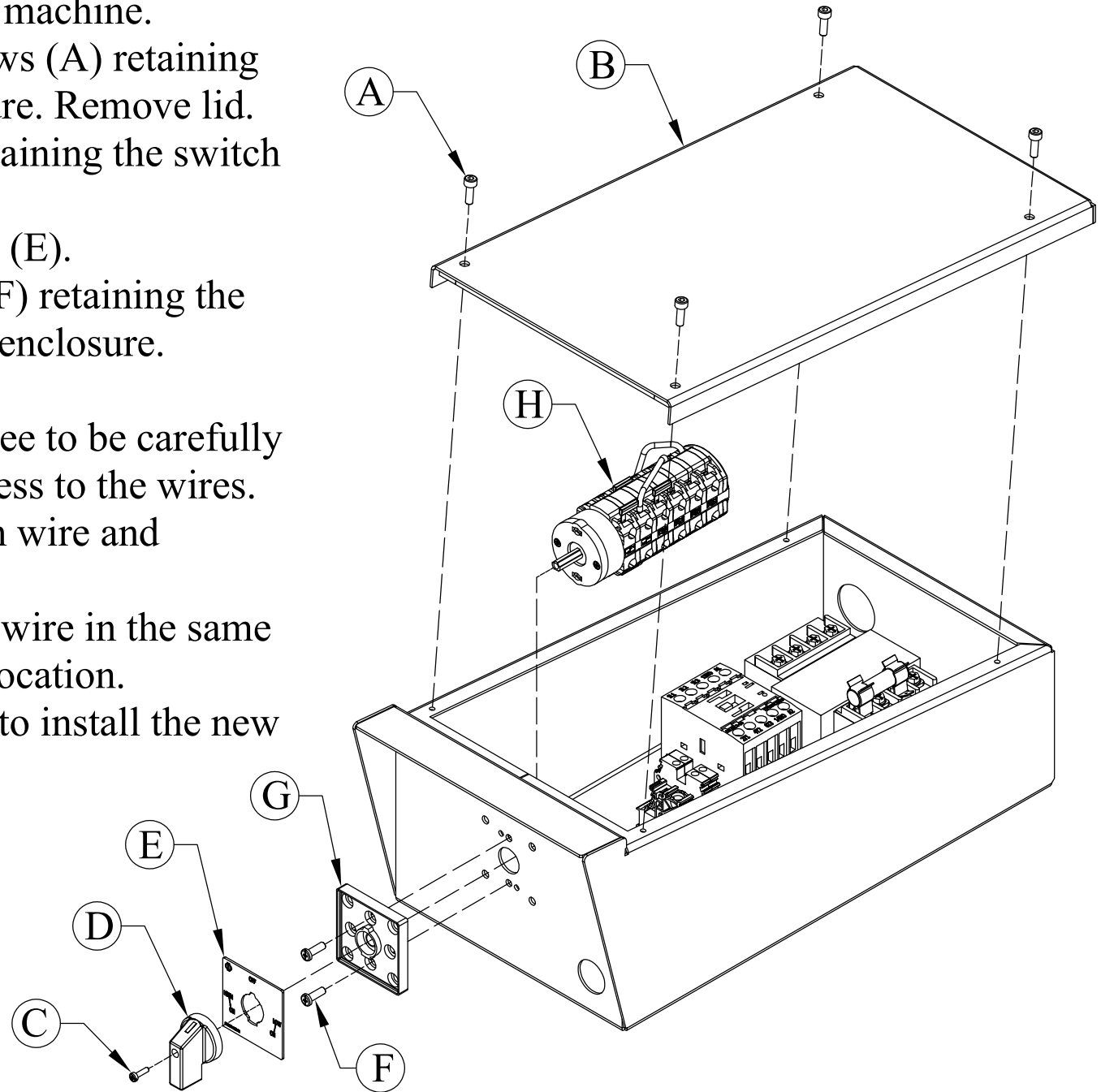

060222 Retrofit Instructions

The following instructions describe how to replace a Klockner Moeller cam switch (left) with a Kraus & Neimer cam switch (right) on the machine(s) listed below.

DISCONNECT POWER TO THE MACHINE BEFORE MODIFICATION.

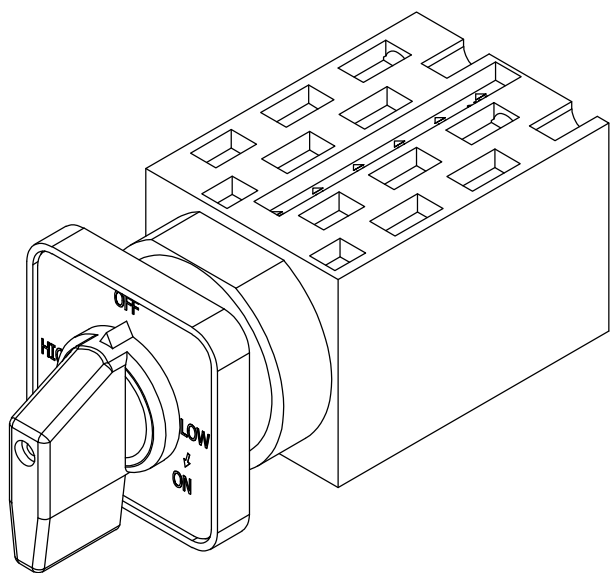

Klockner Moeller

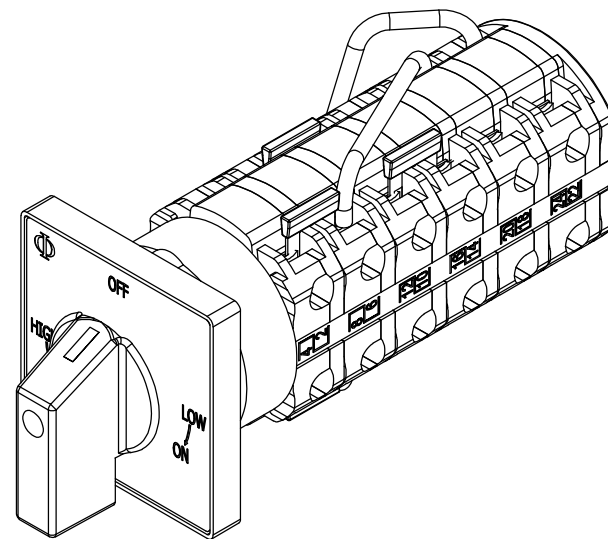
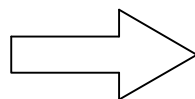

Kraus & Neimer

Applies to Following Machines:

CPO-250: Built 1/95 - 17970695

CPO-275: S/N 17980795 - S/N B39320322

CPO-350: Built 1/95 - S/N B12450422

CPO-350NF: Built 1/95 - S/N B1822NF0509

Switch Removal

1. Disconnect power to the machine.
2. Remove the 4 - M4 screws (A) retaining the lid (B) to the enclosure. Remove lid.
3. Loosen the screw (C) retaining the switch knob (D). Remove knob.
4. Remove the legend plate (E).
5. Remove the 2 - screws (F) retaining the legend holder (G) to the enclosure. Remove legend holder.
6. The switch (H) is now free to be carefully pulled back to allow access to the wires.
7. Note the location of each wire, but do not remove wires from switch at this time.

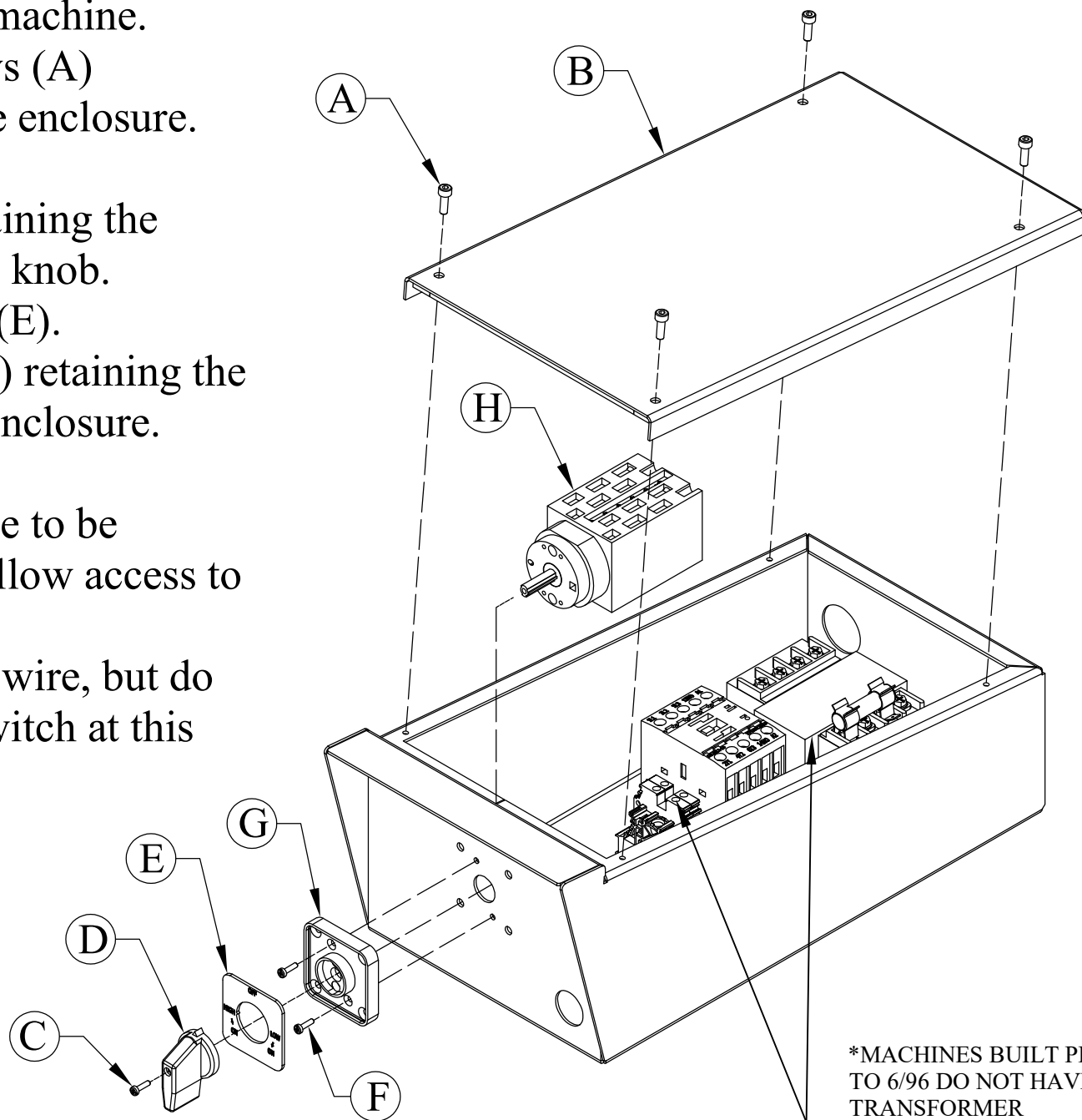

*MACHINES BUILT PRIOR TO 6/96 DO NOT HAVE TRANSFORMER OR ADDITIONAL TERMINALS

Enclosure Modification

1. The new Kraus & Neimer switch features a different mounting screw pattern than the original Klockner Moeller switch. It will be necessary to drill new mounting holes.
2. Using the legend plate holder (A) from the Kraus & Neimer switch as a template, mark the two new holes (B) to be drilled. The new holes will be directly above and below the center hole in the front of the enclosure.
3. Ensure that the old switch and any wires are out of the way, then drill 2 - 3/16" holes (C) where previously marked.
4. Use legend plate to check for fitment.

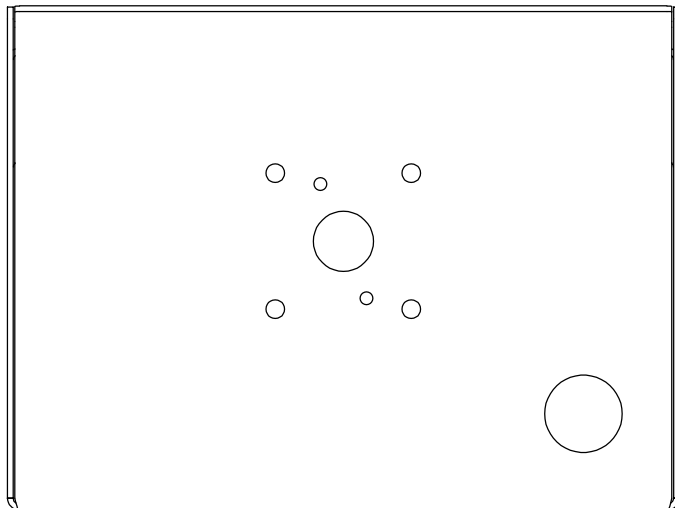

Original

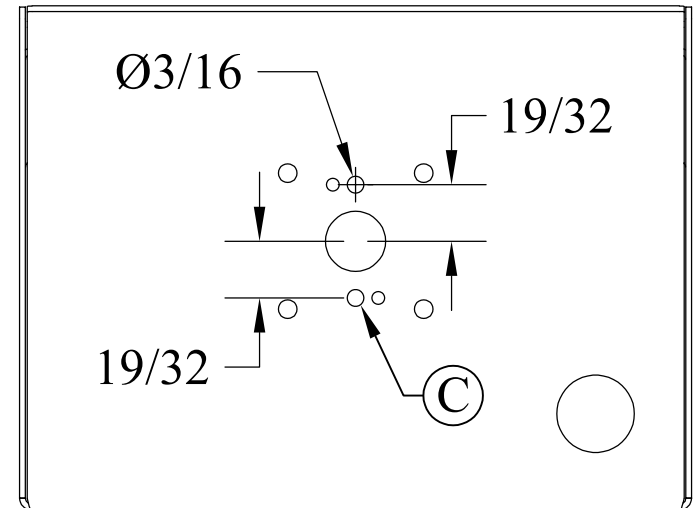
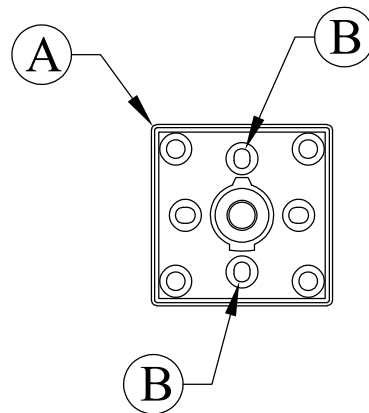

Drilled for Kraus & Neimer

Switch Replacement

1. The new Kraus & Neimer switch is a direct replacement for the original Klockner Moeller switch.
2. Transfer each wire one at a time from the old switch making sure to place each wire in the same terminal number as the original location.
3. Do not remove any of the jumpers supplied with the new switch.
4. Reference the operator's manual supplied with the machine or contact Scotchman Ind. for wiring diagrams specific to your application.
5. Secure the switch (H) and legend holder (G) to the enclosure via the two mounting screws (F).
6. Install the legend plate (E).
7. Install the knob (D) and tighten the retaining screw (C).
8. Re-install the enclosure lid (B) and tighten the retaining screws (A).

