

PRICES FOR #40 PUNCHES & #82 DIES

JANUARY 1, 2025 PRICE LIST

FIRST EDITION

RETAIL PRICES ARE SUBJECT TO CHANGE WITHOUT NOTICE.

All Prices Are F.O.B. Philip, South Dakota.

Minimum Order \$25.00 (Net).

**#40, #45, #49 & SPLIT RING PUNCHES &
#82, #86, 3 INCH & 6 X 6 DIES FOR MODELS:**

**5075, 6012, 6509, 7012, 7575, 9012, 9075, 12012, 2450,
FI 5009, FI 5109, FI 6008, FI 8507, FI 8510,
DO 70, DO 8514, DO 95, DO 100, DO 120, DO 135 & DO 150**

**SCOTCHMAN INDUSTRIES, INC.
180 E US HWY 14 ~ PO BOX 850
PHILIP, SOUTH DAKOTA 57567 U.S.A.**

PHONE: (605) 859-2542

FAX: (605) 859-2499

SCOTCHMAN INDUSTRIES #40 PUNCHES & #82 DIES

JANUARY 1, 2025 PRICE LIST

FIRST EDITION

*RETAIL PRICES ARE SUBJECT TO CHANGE WITHOUT NOTICE!

**** ALL PUNCHES & DIES ARE 1/32" CLEARANCE UNLESS NOTED OTHERWISE ****

#40 PUNCH & #82 DIE PACKAGES (ABSOLUTELY NO SUBSTITUTIONS!)

PART #002543	
ROUND PUNCH & DIE PACKAGE-12 SETS (16th Sizes)	
SIZES (INCH)	LIST PRICE
5/16, 3/8, 7/16, 1/2, 9/16, 5/8, 11/16, 3/4, 13/16, 7/8, 15/16, 1	\$556.00
TOTAL INDIVIDUAL PRICE =	\$556.00
PACKAGE PRICE =	\$385.00
YOUR SAVINGS =	\$171.00

PART #002545	
ROUND PUNCH & DIE PACKAGE-12 SETS (32nd Sizes)	
SIZES (INCH)	LIST PRICE
11/32, 15/32, 17/32, 19/32, 21/32, 23/32, 25/32, 27/32, 29/32, 31/32, 1-1/32, 1-3/16	\$564.00
TOTAL INDIVIDUAL PRICE =	\$564.00
PACKAGE PRICE =	\$385.00
YOUR SAVINGS =	\$179.00

PART #002544	
ROUND PUNCH & DIE PACKAGE-12 SETS (Metric Sizes)	
SIZES (MILLIMETER)	LIST PRICE
8, 10, 12, 14, 16, 18, 20, 22, 24, 28, 30, 32	\$564.00
TOTAL INDIVIDUAL PRICE =	\$564.00
PACKAGE PRICE =	\$415.00
YOUR SAVINGS =	\$149.00

PART #002855		
DELUXE PUNCH & DIE PACKAGE		
SHAPE	SIZES	LIST PRICE
ROUND PUNCH & DIE:	1/4	\$46.00
	9/32	\$46.00
	5/16	\$46.00
	3/8	\$46.00
	13/32	\$46.00
	7/16	\$46.00
	1/2	\$46.00
	9/16	\$46.00
	5/8	\$46.00
	11/16	\$46.00
	3/4	\$46.00
	13/16	\$46.00
	7/8	\$46.00
	15/16	\$46.00
	1	\$50.00
1-1/16	\$50.00	
1-1/8	\$50.00	
1-3/16	\$50.00	
1-1/4	\$62.00	
SQUARE PUNCH & DIE:	1/2	\$138.00
	3/4	\$155.00
	7/8	\$155.00
OVAL PUNCH & DIE:	9/32 x 3/4	\$94.00
	5/16 x 3/4	\$94.00
	9/32 x 1	\$94.00
	5/16 x 1	\$94.00
	13/32 x 1	\$94.00
	7/16 x 1	\$94.00
	17/32 x 1	\$94.00
	9/16 x 1	\$94.00
	9/16 x 1-1/4	\$100.00
	11/16 x 1-1/4	\$100.00
13/16 x 1-1/4	\$100.00	
TOTAL INDIVIDUAL PRICE =		\$2,406.00
PACKAGE PRICE =		\$1,325.00
YOUR SAVINGS =		\$1,081.00

SCOTCHMAN INDUSTRIES #40 PUNCHES & #82 DIES

JANUARY 1, 2025 PRICE LIST

FIRST EDITION

*RETAIL PRICES ARE SUBJECT TO CHANGE WITHOUT NOTICE!

#40 ROUND PUNCHES & # 82 DIES - STOCKING SIZES

PUNCH SIZE	PART #	RETAIL PRICE*
------------	--------	---------------

1/8	018000	\$21.00
5/32	018002	\$21.00
3/16	018004	\$21.00
13/64	018205	\$21.00
7/32	018006	\$21.00
1/4	018008	\$21.00
17/64	018207	\$21.00
9/32	018010	\$21.00
5/16	018012	\$21.00
11/32	018014	\$21.00
3/8	018016	\$21.00
13/32	018018	\$21.00
7/16	018020	\$21.00
15/32	018022	\$21.00
1/2	018024	\$21.00
17/32	018026	\$21.00
9/16	018028	\$21.00
19/32	018030	\$21.00
5/8	018032	\$21.00
21/32	018034	\$21.00
11/16	018037	\$21.00
23/32	018039	\$21.00
3/4	018041	\$21.00
25/32	018120	\$21.00
13/16	018043	\$21.00
27/32	018045	\$21.00
7/8	018047	\$21.00
29/32	018049	\$21.00
15/16	018051	\$21.00
31/32	018053	\$21.00
1	018055	\$21.00
1-1/32	018057	\$21.00
1-1/16	018059	\$21.00
1-3/32	018061	\$21.00
1-1/8	018063	\$21.00
1-5/32	018065	\$21.00
1-3/16	018068	\$21.00
1-7/32	018070	\$21.00
1-1/4	018072	\$33.00

DIE SIZE	PART #	RETAIL PRICE*
----------	--------	---------------

5/32	018003	\$25.00
3/16	018005	\$25.00
7/32	018007	\$25.00
15/64	018206	\$25.00
1/4	018009	\$25.00
9/32	018011	\$25.00
19/64	018208	\$25.00
5/16	018013	\$25.00
11/32	018015	\$25.00
3/8	018017	\$25.00
13/32	018019	\$25.00
7/16	018021	\$25.00
15/32	018023	\$25.00
1/2	018025	\$25.00
17/32	018027	\$25.00
9/16	018029	\$25.00
19/32	018031	\$25.00
5/8	018033	\$25.00
21/32	018036	\$25.00
11/16	018038	\$25.00
23/32	018040	\$25.00
3/4	018042	\$25.00
25/32	018121	\$25.00
13/16	018044	\$25.00
27/32	018046	\$25.00
7/8	018048	\$25.00
29/32	018050	\$25.00
15/16	018052	\$25.00
31/32	018054	\$25.00
1	018056	\$29.00
1-1/32	018058	\$29.00
1-1/16	018060	\$29.00
1-3/32	018062	\$29.00
1-1/8	018064	\$29.00
1-5/32	018067	\$29.00
1-3/16	018069	\$29.00
1-7/32	018071	\$29.00
1-1/4	018073	\$29.00
1-9/32	018075	\$29.00

SCOTCHMAN INDUSTRIES #40 PUNCHES & #82 DIES

JANUARY 1, 2025 PRICE LIST

FIRST EDITION

*RETAIL PRICES ARE SUBJECT TO CHANGE WITHOUT NOTICE!

#40 ROUND PUNCHES & # 82 DIES - STOCKING SIZES

**** PLEASE NOTE: FOR MATERIAL 3/4" & THICKER W/1/16" CLEARANCE ****

PUNCH SIZE	PART #	RETAIL PRICE*
------------	--------	---------------

DIE SIZE	PART #	RETAIL PRICE*
----------	--------	---------------

3/4	018041	\$21.00
25/32	018120	\$21.00
13/16	018043	\$21.00
27/32	018045	\$21.00
7/8	018047	\$21.00
29/32	018049	\$21.00
15/16	018051	\$21.00
31/32	018053	\$21.00
1	018055	\$21.00
1-1/32	018057	\$21.00
1-1/16	018059	\$21.00
1-3/32	018061	\$21.00
1-1/8	018063	\$21.00
1-5/32	018065	\$21.00
1-3/16	018068	\$21.00
1-7/32	018070	\$21.00
1-1/4	018072	\$33.00

13/16	018044	\$25.00
27/32	018046	\$25.00
7/8	018048	\$25.00
29/32	018050	\$25.00
15/16	018052	\$25.00
31/32	018054	\$25.00
1	018056	\$29.00
1-1/32	018058	\$29.00
1-1/16	018060	\$29.00
1-3/32	018062	\$29.00
1-1/8	018064	\$29.00
1-5/32	018067	\$29.00
1-3/16	018069	\$29.00
1-7/32	018071	\$29.00
1-1/4	018073	\$29.00
1-9/32	018075	\$29.00
1-5/16**	018077	\$85.00

** #86 DIE - REQUIRES 2-1/2" O.D. DIE HOLDER INSERT

#45 ROUND PUNCHES & # 86 DIES - STOCKING SIZES

**** PLEASE NOTE: FOR MATERIAL 3/4" & THICKER W/1/16" CLEARANCE ****

1-9/32	018074	\$65.00
1-5/16	018076	\$65.00
1-11/32	018151	\$65.00
1-3/8	018078	\$65.00
1-13/32	018153	\$65.00
1-7/16	018081	\$65.00
1-15/32	018154	\$65.00
1-1/2	018084	\$65.00
1-17/32	018163	\$65.00
1-9/16	018086	\$65.00

1-11/32	018152	\$85.00
1-3/8	018080	\$85.00
1-13/32	018157	\$85.00
1-7/16	018083	\$85.00
1-15/32	018155	\$85.00
1-1/2	018085	\$85.00
1-17/32	018158	\$85.00
1-9/16	018087	\$85.00
1-19/32	018161	\$85.00
1-5/8	018088	\$85.00

SCOTCHMAN INDUSTRIES #40 PUNCHES & #82 DIES

JANUARY 1, 2025 PRICE LIST

FIRST EDITION

*RETAIL PRICES ARE SUBJECT TO CHANGE WITHOUT NOTICE!

#45 ROUND PUNCHES & #86 DIES - STOCKING SIZES

PUNCH SIZE	PART #	RETAIL PRICE*
1-9/32	018074	\$65.00
1-5/16	018076	\$65.00
1-11/32	018151	\$65.00
1-3/8	018078	\$65.00
1-13/32	018153	\$65.00
1-7/16	018081	\$65.00
1-15/32	018154	\$65.00
1-1/2	018084	\$65.00
1-17/32	018163	\$65.00
1-9/16	018086	\$65.00

DIE SIZE	PART #	RETAIL PRICE*
1-5/16	018077	\$85.00
1-11/32	018152	\$85.00
1-3/8	018080	\$85.00
1-13/32	018157	\$85.00
1-7/16	018083	\$85.00
1-15/32	018155	\$85.00
1-1/2	018085	\$85.00
1-17/32	018158	\$85.00
1-9/16	018087	\$85.00
1-19/32	018161	\$85.00

#49 ROUND PUNCHES & DIES - STOCKING SIZES

(ONLY FOR MODELS 12012-24M, DO 120/200M, DO 135/220M, & DO 150/240M)

1-5/8	018400	\$131.00
1-11/16	018405	\$131.00
1-3/4	018410	\$131.00
1-13/16	018415	\$131.00
1-7/8	018420	\$131.00
1-15/16	018423	\$131.00
2	018425	\$131.00

1-21/32 (3" OD Die)	018311	\$135.00
1-23/32 (3" OD Die)	018316	\$135.00
1-25/32 (3" OD Die)	018321	\$135.00
1-27/32 (3" OD Die)	018326	\$135.00
1-29/32 (3" OD Die)	018327	\$135.00
1-31/32 (3" OD Die)	018328	\$135.00
2-1/32 (6 X 6 Die)	018331	\$320.00

SPLIT RING ROUND PUNCHES & 3" & 6 X 6 ROUND DIES - STOCKING SIZES

1-5/8	018310	\$133.00
1-3/4	018320	\$133.00
2	018330	\$133.00
2-1/4	018340	\$185.00
2-1/2	018350	\$195.00
2-3/4	018354	\$235.00
3	018360	\$235.00

1-21/32 (3" OD Die)	018311	\$135.00
1-25/32 (3" OD Die)	018321	\$135.00
2-1/32 (6 X 6 Die)	018331	\$320.00
2-9/32 (6 X 6 Die)	018341	\$320.00
2-17/32 (6 X 6 Die)	018351	\$320.00
2-25/32 (6 X 6 Die)	018355	\$320.00
3-1/32 (6 X 6 Die)	018361	\$320.00

#82 ROUND OFFSET DIES - STOCKING SIZES

DIE SIZE	PART #	RETAIL PRICE*
9/32	023004	\$31.00
5/16	023005	\$31.00
11/32	023006	\$31.00
3/8	023007	\$31.00
13/32	023008	\$31.00
7/16	023009	\$31.00
15/32	023010	\$31.00
1/2	023011	\$31.00
17/32	023012	\$31.00
9/16	023013	\$31.00
19/32	023014	\$31.00

DIE SIZE	PART #	RETAIL PRICE*
5/8	023015	\$31.00
21/32	023016	\$31.00
11/16	023017	\$31.00
23/32	023018	\$31.00
3/4	023019	\$31.00
25/32	023020	\$31.00
13/16	023021	\$31.00
27/32	023022	\$31.00
7/8	023023	\$31.00
29/32	023024	\$31.00

SCOTCHMAN INDUSTRIES #40 PUNCHES & #82 DIES

JANUARY 1, 2025 PRICE LIST

FIRST EDITION

*RETAIL PRICES ARE SUBJECT TO CHANGE WITHOUT NOTICE!

#40 ROUND METRIC PUNCHES AND #82 ROUND DIES - STOCKING SIZES

PUNCH SIZE	PART #	RETAIL PRICE*
------------	--------	---------------

DIE SIZE	PART #	RETAIL PRICE*
----------	--------	---------------

5mm	021406	\$21.00
6mm	021410	\$21.00
7mm	021414	\$21.00
8mm	021418	\$21.00
9mm	021422	\$21.00
10mm	021426	\$21.00
11mm	021430	\$21.00
12mm	021434	\$21.00
13mm	021438	\$21.00
14mm	021442	\$21.00
15mm	021446	\$21.00
16mm	021450	\$21.00
17mm	021454	\$21.00
18mm	021458	\$21.00
19mm	021462	\$21.00
20mm	021466	\$21.00
21mm	021470	\$21.00
22mm	021474	\$21.00
23mm	021478	\$21.00
24mm	021482	\$21.00
25mm	021486	\$21.00
26mm	021490	\$21.00
27mm	021494	\$21.00
28mm	021498	\$21.00
29mm	021502	\$21.00
30mm	021506	\$21.00
31mm	021510	\$21.00
32mm	021514	\$21.00

5.8mm	021407	\$25.00
6.8mm	021411	\$25.00
7.8mm	021415	\$25.00
8.8mm	021419	\$25.00
9.8mm	021423	\$25.00
10.8mm	021427	\$25.00
11.8mm	021431	\$25.00
12.8mm	021435	\$25.00
13.8mm	021439	\$25.00
14.8mm	021443	\$25.00
15.8mm	021447	\$25.00
16.8mm	021451	\$25.00
17.8mm	021455	\$25.00
18.8mm	021459	\$25.00
19.8mm	021463	\$25.00
20.8mm	021467	\$25.00
21.8mm	021471	\$25.00
22.8mm	021475	\$25.00
23.8mm	021479	\$25.00
24.8mm	021483	\$25.00
25.8mm	021487	\$29.00
26.8mm	021491	\$29.00
27.8mm	021495	\$29.00
28.8mm	021499	\$29.00
29.8mm	021503	\$29.00
30.8mm	021507	\$29.00
31.8mm	021511	\$29.00
32.8mm	021515	\$29.00

SCOTCHMAN INDUSTRIES #40 PUNCHES & #82 DIES

JANUARY 1, 2025 PRICE LIST

FIRST EDITION

*RETAIL PRICES ARE SUBJECT TO CHANGE WITHOUT NOTICE!

**ALL SHAPED PUNCHES ARE KEYED STANDARD
FOR SAFE & POSITIVE PUNCH ALIGNMENT.**

#40 OVAL PUNCHES AND #82 DIES - STOCKING SIZES

PUNCH SIZE	PART #	RETAIL PRICE*	DIE SIZE	PART #	RETAIL PRICE*
9/32 x 3/4	020000	\$47.00	5/16 x 25/32	020001	\$47.00
5/16 x 3/4	020002	\$47.00	11/32 x 25/32	020003	\$47.00
11/32 x 3/4	020004	\$47.00	3/8 x 25/32	020005	\$47.00
3/8 x 3/4	020006	\$47.00	13/32 x 25/32	020007	\$47.00
13/32 x 3/4	020008	\$47.00	7/16 x 25/32	020009	\$47.00
7/16 x 3/4	020010	\$47.00	15/32 x 25/32	020011	\$47.00
15/32 x 3/4	020012	\$47.00	1/2 x 25/32	020013	\$47.00
1/2 x 3/4	020014	\$47.00	17/32 x 25/32	020015	\$47.00
17/32 x 3/4	020016	\$47.00	9/16 x 25/32	020017	\$47.00
9/16 x 3/4	020018	\$47.00	19/32 x 25/32	020019	\$47.00
19/32 x 3/4	020020	\$47.00	5/8 x 25/32	020021	\$47.00
5/8 x 3/4	020022	\$47.00	21/32 x 25/32	020023	\$47.00
1/4 x 1	020105	\$47.00	9/32 x 1-1/32	020106	\$47.00
9/32 x 1	020024	\$47.00	5/16 x 1-1/32	020025	\$47.00
5/16 x 1	020026	\$47.00	11/32 x 1-1/32	020027	\$47.00
11/32 x 1	020028	\$47.00	3/8 x 1-1/32	020029	\$47.00
3/8 x 1	020030	\$47.00	13/32 x 1-1/32	020031	\$47.00
13/32 x 1	020032	\$47.00	7/16 x 1-1/32	020033	\$47.00
7/16 x 1	020034	\$47.00	15/32 x 1-1/32	020035	\$47.00
15/32 x 1	020036	\$47.00	1/2 x 1-1/32	020037	\$47.00
1/2 x 1	020038	\$47.00	17/32 x 1-1/32	020039	\$47.00
17/32 x 1	020040	\$47.00	9/16 x 1-1/32	020041	\$47.00
9/16 x 1	020042	\$47.00	19/32 x 1-1/32	020043	\$47.00
19/32 x 1	020044	\$47.00	5/8 x 1-1/32	020045	\$47.00
5/8 x 1	020046	\$47.00	21/32 x 1-1/32	020047	\$47.00
21/32 x 1	020048	\$47.00	11/16 x 1-1/32	020049	\$47.00
11/16 x 1	020050	\$47.00	23/32 x 1-1/32	020051	\$47.00
23/32 x 1	020052	\$47.00	3/4 x 1-1/32	020053	\$47.00
3/4 x 1	020054	\$47.00	25/32 x 1-1/32	020055	\$47.00
25/32 x 1	020056	\$47.00	13/16 x 1-1/32	020057	\$47.00
13/16 x 1	020058	\$47.00	27/32 x 1-1/32	020059	\$47.00
7/8 x 1	020060	\$47.00	29/32 x 1-1/32	020061	\$47.00
15/16 x 1	020062	\$47.00	31/32 x 1-1/32	020063	\$47.00
9/32 x 1-1/4	020064	\$50.00	5/16 x 1-9/32	020065	\$50.00
5/16 x 1-1/4	020066	\$50.00	11/32 x 1-9/32	020067	\$50.00
11/32 x 1-1/4	020068	\$50.00	3/8 x 1-9/32	020069	\$50.00
3/8 x 1-1/4	020070	\$50.00	13/32 x 1-9/32	020071	\$50.00
13/32 x 1-1/4	020072	\$50.00	7/16 x 1-9/32	020073	\$50.00

SCOTCHMAN INDUSTRIES #40 PUNCHES & #82 DIES

JANUARY 1, 2025 PRICE LIST

FIRST EDITION

*RETAIL PRICES ARE SUBJECT TO CHANGE WITHOUT NOTICE!

**ALL SHAPED PUNCHES ARE KEYED STANDARD
FOR SAFE & POSITIVE PUNCH ALIGNMENT.**

#40 OVAL PUNCHES AND # 82 DIES - STOCKING SIZES (CONT'D)

PUNCH SIZE	PART #	RETAIL PRICE*
------------	--------	---------------

7/16 x 1-1/4	020074	\$50.00
15/32 x 1-1/4	020076	\$50.00
1/2 x 1-1/4	020078	\$50.00
17/32 x 1-1/4	020080	\$50.00
9/16 x 1-1/4	020082	\$50.00
19/32 x 1-1/4	020084	\$50.00
5/8 x 1-1/4	020086	\$50.00
21/32 x 1-1/4	020088	\$50.00
11/16 x 1-1/4	020090	\$50.00
23/32 x 1-1/4	020092	\$50.00
3/4 x 1-1/4	020094	\$50.00
25/32 x 1-1/4	020096	\$50.00
13/16 x 1-1/4	020098	\$50.00
7/ 8x 1-1/4	020100	\$50.00
15/16 x 1-1/4	020103	\$50.00

DIE SIZE	PART #	RETAIL PRICE*
----------	--------	---------------

15/32 x 1-9/32	020075	\$50.00
1/2 x 1-5/16	020113	\$50.00
1/2 x 1-9/32	020077	\$50.00
17/32 x 1-9/32	020079	\$50.00
9/16 x 1-9/32	020081	\$50.00
19/32 x 1-9/32	020083	\$50.00
5/8 x 1-5/16	020115	\$50.00
5/8 x 1-9/32	020085	\$50.00
21/32 x 1-9/32	020087	\$50.00
11/16 x 1-9/32	020089	\$50.00
23/32 x 1-9/32	020091	\$50.00
3/4 x 1-5/16	020117	\$50.00
3/4 x 1-9/32	020093	\$50.00
25/32 x 1-9/32	020095	\$50.00
13/16 x 1-9/32	020097	\$50.00
27/32 x 1-9/32	020099	\$50.00
7/8 x 1-5/16	020119	\$50.00
29/32 x 1-9/32	020102	\$50.00
31/32 x 1-9/32	020104	\$50.00
1 x 1-5/16	020121	\$50.00

#45 OVAL PUNCHES AND # 86 DIES - STOCKING SIZES

7/16 x 1-1/2	020122	\$95.00
9/16 x 1-1/2	020124	\$95.00
11/16 x 1-1/2	020126	\$95.00
13/16 x 1-1/2	020128	\$95.00
15/16 x 1-1/2	020130	\$95.00

15/32 x 1-17/32	020123	\$145.00
19/32 x 1-17/32	020125	\$145.00
23/32 x 1-17/32	020127	\$145.00
27/32 x 1-17/32	020129	\$145.00
31/32 x 1-17/32	020131	\$145.00

SCOTCHMAN INDUSTRIES #40 PUNCHES & #82 DIES

JANUARY 1, 2025 PRICE LIST

FIRST EDITION

*RETAIL PRICES ARE SUBJECT TO CHANGE WITHOUT NOTICE!

**ALL SHAPED PUNCHES ARE KEYED STANDARD
FOR SAFE & POSITIVE PUNCH ALIGNMENT.**

#40 SQUARE PUNCHES AND # 82 SQUARE DIES - STOCKING SIZES

PUNCH SIZE	PART #	RETAIL PRICE*
------------	--------	---------------

1/4	018089	\$50.00
9/32	018165	\$50.00
5/16	018091	\$50.00
11/32	018167	\$50.00
3/8	018099	\$50.00
13/32	018101	\$50.00
7/16	018119	\$50.00
15/32	018103	\$50.00
1/2	018105	\$50.00
17/32	018107	\$50.00
9/16	018109	\$50.00
19/32	018097	\$50.00
5/8	018122	\$50.00
21/32	018111	\$50.00
11/16	018093	\$50.00
23/32	018169	\$50.00
3/4	018113	\$50.00
25/32	018115	\$50.00
13/16	018095	\$50.00
27/32	018171	\$50.00
7/8	018117	\$50.00

DIE SIZE	PART #	RETAIL PRICE*
----------	--------	---------------

9/32	018090	\$88.00
5/16	018166	\$88.00
11/32	018092	\$88.00
3/8	018168	\$88.00
13/32	018100	\$88.00
7/16	018102	\$88.00
15/32	018150	\$88.00
1/2	018104	\$88.00
17/32	018106	\$88.00
9/16	018108	\$88.00
19/32	018110	\$88.00
5/8	018098	\$88.00
21/32	018123	\$88.00
11/16	018112	\$88.00
23/32	018094	\$93.00
3/4	018170	\$93.00
25/32	018114	\$105.00
13/16	018116	\$105.00
27/32	018096	\$105.00
7/8	018172	\$105.00
29/32	018118	\$105.00

#45 SQUARE PUNCHES AND # 86 SQUARE DIES - STOCKING SIZES

29/32	018173	\$115.00
15/16	018175	\$115.00
31/32	018177	\$115.00
1	018125	\$115.00
1-1/32	018220	\$115.00

15/16	018174	\$150.00
31/32	018176	\$150.00
1	018178	\$150.00
1-1/32	018126	\$150.00
1-1/16	018221	\$150.00

SCOTCHMAN INDUSTRIES #40 PUNCHES & #82 DIES

JANUARY 1, 2025 PRICE LIST

FIRST EDITION

*RETAIL PRICES ARE SUBJECT TO CHANGE WITHOUT NOTICE!

**ALL SHAPED PUNCHES ARE KEYED STANDARD
FOR SAFE & POSITIVE PUNCH ALIGNMENT.**

#40 CORNER TURNING PUNCH AND # 82 DIES - STOCKING SIZES

PUNCH SIZE	PART #	RETAIL PRICE*	DIE SIZE	PART #	RETAIL PRICE*
1/2	18200	(SOLD AS SET ONLY)	1/2	018201	\$185.00

#40 HEXAGON PUNCHES & #82 DIES - STOCKING SIZES

7/16	022042	\$65.00	15/32	022043	\$115.00
1/2	022046	\$65.00	17/32	022047	\$115.00
11/16	022058	\$65.00	23/32	022059	\$115.00
3/4	022062	\$65.00	25/32	022063	\$115.00

SPECIAL PUNCHES & DIES - NON-STOCKING SIZES

SPECIAL ROUNDS

RETAIL PRICE*		
PUNCH	DIE	SET

SIZES FROM

1/8" to 1-1/4" (#40 Punch, #82 Die)	\$75.00	\$75.00	\$150.00
1-9/32" to 1-9/16" (#45 Punch, #86 Die)	\$95.00	\$115.00	\$210.00
1-19/32" to 1-15/16" (Split Ring Punch, 3" OD Die)	\$155.00	\$175.00	\$330.00
1-31/32" to 2-7/16" (Split Ring Punch, 6 X 6 Die)	\$220.00	\$310.00	\$530.00
2-15/32" to 2-15/16" (Split Ring Punch, 6 X 6 Die)	\$240.00	\$310.00	\$550.00
2-31/32" to 3-15/32" (Split Ring Punch, 6 X 6 Die)	\$260.00	\$310.00	\$570.00
3-1/2" to 4" (Split Ring Punch, 6 X 6 Die)	\$380.00	\$310.00	\$690.00

SPECIAL ROUND ECCENTRIC DIES (#82 ONLY)

1/8" to 1" Diameter	\$100.00
---------------------	----------

SPECIAL HEXAGONS

SIZES FROM

5/16" to 1-1/16" (#40 Punch, #82 Die)	\$115.00	\$160.00	\$275.00
1-5/64" to 1-9/32" (#45 Punch, #86 Die)	\$150.00	\$185.00	\$335.00
1-19/64" to 1-23/32" (Split Ring Punch, 3" OD Die)	\$165.00	\$230.00	\$395.00
1-47/64" to 2-1/8" (Split Ring Punch, 6 X 6 Die)	\$190.00	\$330.00	\$520.00
2-9/64" to 2-9/16" (Split Ring Punch, 6 X 6 Die)	\$230.00	\$330.00	\$560.00
2-37/64" to 3" (Split Ring Punch, 6 X 6 Die)	\$270.00	\$330.00	\$600.00

SCOTCHMAN INDUSTRIES #40 PUNCHES & #82 DIES

JANUARY 1, 2025 PRICE LIST

FIRST EDITION

*RETAIL PRICES ARE SUBJECT TO CHANGE WITHOUT NOTICE!

**ALL SHAPED PUNCHES ARE KEYED STANDARD
FOR SAFE & POSITIVE PUNCH ALIGNMENT.**

SPECIAL OVALS

SIZES FROM	RETAIL PRICE*		
	PUNCH	DIE	SET
1/4" to 1-1/4" (#40 Punch, #82 Die)	\$95.00	\$125.00	\$220.00
1-17/64" to 1-1/2" (#45 Punch, #86 Die)	\$125.00	\$155.00	\$280.00
1-33/64" to 1-9/16" (#45 Punch, #86 Die)	\$155.00	\$155.00	\$310.00
1-19/32" to 1-15/16" (Split Ring Punch, 3" OD Die)	\$155.00	\$180.00	\$335.00
1-61/64" to 2-1/32" (Split Ring Punch, 3" OD Die)	\$180.00	\$180.00	\$360.00
2-3/64" to 2-7/16" (Split Ring Punch, 6 X 6 Die)	\$180.00	\$298.00	\$478.00
2-29/64" to 2-15/16" (Split Ring Punch, 6 X 6 Die)	\$215.00	\$298.00	\$513.00
2-61/64" to 3-7/16" (Split Ring Punch, 6 X 6 Die)	\$325.00	\$298.00	\$623.00
3-29/64" to 4" (Split Ring Punch, 6 X 6 Die)	\$455.00	\$325.00	\$780.00

SPECIAL OVAL OFFSET DIES (#82 ONLY)

Must Specify Front To Back or Left To Right \$130.00

SPECIAL CORNER TURNING (1/4" IS THE MAXIMUM THICKNESS)

3/4" Radius (#45 Punch, #86 Die)	(SOLD AS SET ONLY!)	\$370.00
1" Radius (Split Ring Punch, 3" OD Die)	(SOLD AS SET ONLY!)	\$475.00
1-1/4" Radius (Split Ring Punch, 6 X 6 Die)	(SOLD AS SET ONLY!)	\$630.00
1-1/2" Radius (Split Ring Punch, 6 X 6 Die)	(SOLD AS SET ONLY!)	\$640.00
1-3/4" Radius (Split Ring Punch, 6 X 6 Die)	(SOLD AS SET ONLY!)	\$765.00
2" Radius (Split Ring Punch, 6 X 6 Die)	(SOLD AS SET ONLY!)	\$920.00

(OTHER SIZES AVAILABLE, PLEASE CALL FOR PRICING!)

SPECIAL TRIM & CUTOFF (1/4" IS THE MAXIMUM THICKNESS)

1/2" - Radius 9/32" (#40 Punch, #82 Die)	\$155.00	\$145.00	\$300.00
3/4" - Radius 7/16" (#45 Punch, #86 Die)	\$205.00	\$180.00	\$385.00
1" - Radius 9/16" (Split Ring Punch, #86 Die)	\$315.00	\$180.00	\$495.00
1-1/4" - Radius 3/4" (Split Ring Punch, 3" OD Die)	\$320.00	\$230.00	\$550.00
1-1/2" - Radius 7/8" (Split Ring Punch, 6 X 6 Die)	\$415.00	\$320.00	\$735.00
2" - Radius 1-1/8" (Split Ring Punch, 6 X 6 Die)	\$545.00	\$365.00	\$910.00

(OTHER SIZES AVAILABLE, PLEASE CALL FOR PRICING!)

SCOTCHMAN INDUSTRIES #40 PUNCHES & #82 DIES

JANUARY 1, 2025 PRICE LIST

FIRST EDITION

*RETAIL PRICES ARE SUBJECT TO CHANGE WITHOUT NOTICE!

**ALL SHAPED PUNCHES ARE KEYED STANDARD
FOR SAFE & POSITIVE PUNCH ALIGNMENT.**

SPECIAL SQUARES & RECTANGLES - NON-STOCKING SIZES (1/4" IS THE SMALLEST)

SIZES FROM MAXIMUM DIAGONAL	RETAIL PRICE*		
	PUNCH	DIE	SET
1-1/4" (#40 Punch, #82 Die)	\$80.00	\$100.00	\$180.00
1-7/16" (#45 Punch, #82 Die)	\$130.00	\$100.00	\$230.00
1-9/16" (#45 Punch, #86 Die)	\$130.00	\$155.00	\$285.00
1-3/4" (Split Ring Punch, #86 Die)	\$165.00	\$155.00	\$320.00
2" (Split Ring Punch, 3" OD Die)	\$165.00	\$215.00	\$380.00
2-1/2" (Split Ring Punch, 6 X 6 Die)	\$180.00	\$350.00	\$530.00
3" (Split Ring Punch, 6 X 6 Die)	\$215.00	\$350.00	\$565.00
3-1/2" (Split Ring Punch, 6 X 6 Die)	\$295.00	\$350.00	\$645.00
4" (Split Ring Punch, 6 X 6 Die)	\$425.00	\$370.00	\$795.00

SPECIAL PUNCH & DIE OPTIONS (FOR SPECIALS ONLY)

Chisel Points Up To 1-1/2"	ADD	\$100.00
Chisel Points 1-33/64" & Up	ADD	\$100.00
Bevel Offset Die (Saw Tooth)	ADD	\$280.00

PUNCH & DIE DIMENSIONS

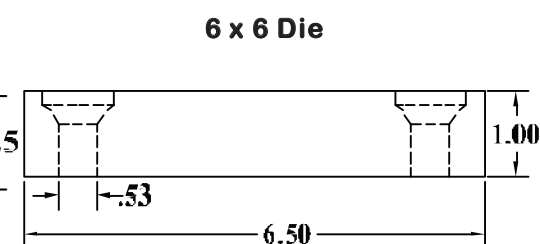
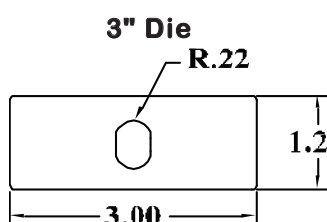
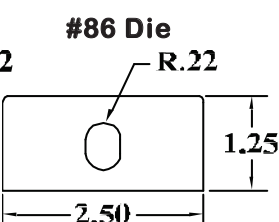
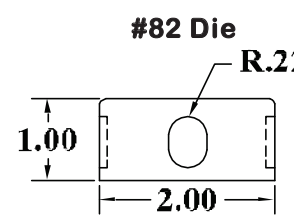
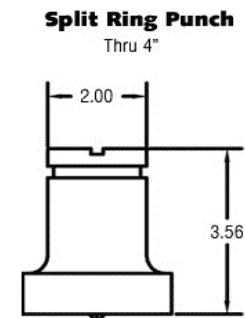
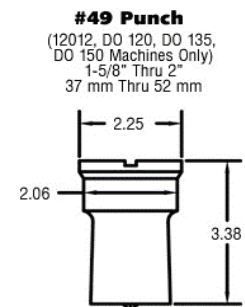
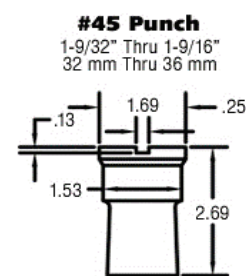
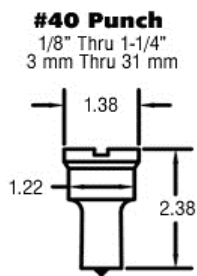

OVER THE YEARS, SCOTCHMAN INDUSTRIES HAS DESIGNED AND MANUFACTURED THOUSANDS OF SPECIAL SIZES AND SHAPES OF PUNCHES AND DIES.

SHOW BELOW ARE ONLY A FEW OF THE SHAPES, TO GIVE YOU AN IDEA OF WHAT IS AVAILABLE.

IF YOU HAVE AN APPLICATION THAT REQUIRES PUNCHING, FORMING, NOTCHING OR BENDING OF A SPECIAL PART, GIVE US A CALL AT

(800) 843-8844 OR FAX US YOUR DRAWING AT (800) 843-5545.

